

The RMU3XL is a large capacity remote monitor with an integral GPS synchronized current interruption controller. The two piece device is equipped with 44 configurable analog measurement channels capable of accurately measuring a wide range of DC and AC signals. Measurement data and interruption control is remotely accessible through an intuitive Internet web interface called corView.

### RMU3XL Features:

- 44 galvanically isolated analog input channels
- Satellite or cellular communications for maximum service coverage
- Economical fixed rate operational communications costs
- High reliability, long operational life design
- Each analog channel is bi-polar with 150mV (50 and 100mV current shunts), 22V, 150V and 4-20mA measurement ranges
- Each analog channel can be configured to measure DC or True RMS AC (i.e. induced AC measurements)
- DC analog channels include >65dB of 50/60Hz AC rejection
- All analog channels are high impedance and allow direct connection to reference half-cells
- Measurement channels are arranged in 11 groups of 4 inputs
- Analog channel measurement accuracy of +/-0.5% DC and +/-1% AC FS over -40° to +70°C (-40 to +158°F)
- Programmable low and high alarm window capability on each analog channel with report by exception facilities
- Scheduled reporting of data based on customer selected plan
- Site GPS position information transmitted to corView host
- Internal temperature measurement and reporting
- Each channel has independent high voltage lightning protection
- No connection to Earth ground for maximum lightning immunity
- A single digital input can provide door alarm or tamper detection
- Internal wide temperature range rechargeable battery system
- Integral antennas provide superior communications
- Integrated RMU3 configuration interface provides direct USB connection
- Easy configuration through a PC application
- Antenna is a Type 3 Enclosure – Suitable for outdoor use
- Operating temperature range -40°F to +158°F (-40°C to +70°C)
- Optional NEMA4X J-box enclosure available (A20B04RMU3X)

### corView Features:

- Firewall-friendly Internet web browser access
- corView is intuitive and easy to use
- Password protected user access
- Multiple client user accounts with configurable permission levels
- Display screens for Rectifiers, Test Points, Bond and Coupons
- Graphically displays sites using Google Maps®
- Sites can be grouped (i.e. regions, etc)
- Powerful data and site sorting functions
- Data can be exported in CSV and Excel (via XML) formats
- corView archives 3 years of measurement data
- Color coded display of alarms and site status
- Configurable email call list for alarm conditions
- Low battery warning and alerting
- Alerting for missed communications from sites
- System performance email reports
- Optional data export to 3rd party compliance software



Measurement Terminal Block

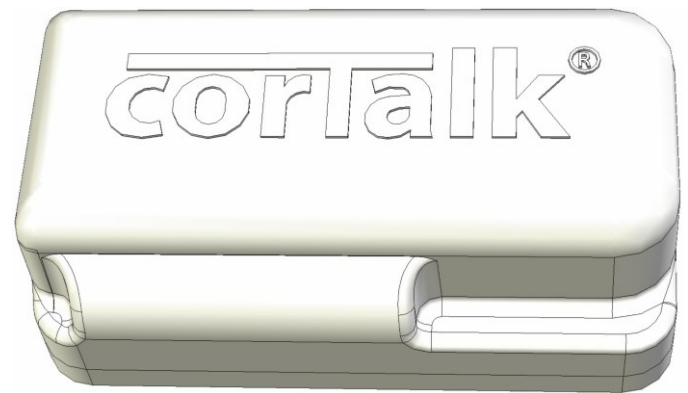

Antenna (Satellite or LTE Cellular)

**A20A00RMU35** RMU3XL-S 44 Channel Remote Monitoring Unit - Satellite Version  
Includes: RMU3X-B 44 channel measurement block, satellite antenna transmitter c/w batteries, plastic NPT fitting, 1 mtr (3.2 ft) interconnection cable assy, RMU3X-B mounting screws, and USB programming cable.

**A20A00RMU36** RMU3XL-G 44 Channel Remote Monitoring Unit - Cellular Version  
Includes: RMU3X-B 44 channel measurement block, Cellular antenna transmitter c/w batteries, plastic NPT fitting, 1 mtr (3.2 ft) interconnection cable assy, RMU3X-B mounting screws, and USB programming cable.